

Boat International

2003

INTERIORS



A BOAT INTERNATIONAL PUBLICATION

SOLAIA

Exterior & Interior Design • Felix Buytendijk



With her allusion to Aztec sun worship, it is no surprise that the 40 metre Hakvoort motor yacht *Solaiia* has a particularly impressive sun deck, especially when the hand at work in styling and design is Felix Buytendijk. The owner's requirements centred on a well-shaded area for alfresco meals, along with a spa pool, sunpads, a social sitting area, and somewhere to simply

take in the passing scenery from this advantageous height above sea level. It was also paramount that outside areas should have minimal maintenance requirements, so there is no varnished wood, even to the extent of shunning teak caprails. Every material chosen is both durable and aesthetically suited to its role. With no better example of this being the deck itself, which is precisely planked in natural teak, the king of woods in terms of stability and hardness.

Reflecting Felix Buytendijk's flowing interior design, the sun deck uses curved shapes which are not only easy on the eye and contact with the human body, but also enhance the impression of spaciousness. Technical constraints were turned to advantage. For example, the two backswept side fins which house air-conditioning machinery for the main and bridge decks, ducting for the galley and laundry exhausts, also conceal a Lödige dumb waiter and support not only the mast, but an enlarged transverse wing acting as a fixed bimini.

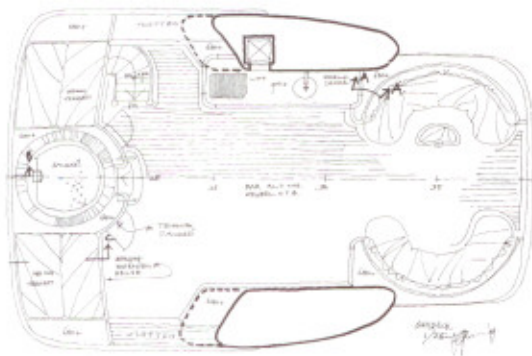



Faithful reflections in the white Awlgrip finish of the structure are testament both to the fairness of Hakvoort's aluminium work and the skills of the applicators at Klaver Yachtpainting. The mast is no small feat of design itself, as the antennae for Furuno radars, SeaTel satellite television, Kahlenberg air horns and the essentials of navigation, communication and illumination each required separate platforms and convenient access for their maintenance.

The sweeping curves of the side fins and wing are echoed both in the structure of sun deck furniture and



in the routes around it. Entry to the sun deck is via a staircase aft on the port side, protected by a stainless steel balustrade that turns inboard towards the solar altar of large sunpads flanking Aqua Garant's Cleopatra spa pool. This pool can also be covered to make a further circular sunpad if required. Outboard of here the liferafts are recessed into the bulwark fairings, so as to be invisible in everyday living, yet easily launched in an emergency. The way forward swings around the bow-shaped bar which is placed directly beneath the wing on the port side, illuminated by recessed Savage downlights and discreet speakers overhead. Facilities behind the bar include an electric barbecue grill from Palux, refrigerator, icemaker, and a sink with U-line hardware. The bar itself is at table height for dining and is surfaced in Malachite Corian. This shade of green coordinates with the background colour of faux air grilles which serve to break up the mass of the vertical fins, improving the streamlining effect and matching the faux grille seen forward on the superstructure at main deck level with the genuine engine

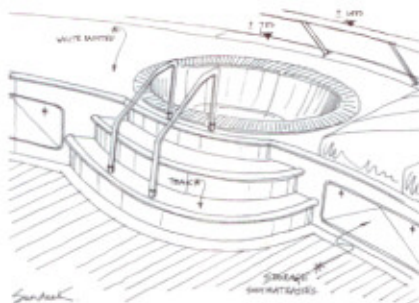

room grilles in the aft corners. The starboard space beneath the wing is left open for moveable seating and access to technical spaces, while immediately forward of here the central thoroughfare passes between semi-circular settees, each with a half-moon table also

surfaced in the Malachite Corian. Shade can be extended to this area by a 2 metre awning that unrolls from beneath the forward edge of the wing, while large sun umbrellas shade the tables. The combination of hard and soft shade structures creates a most flexible elevated outdoor room. Settee fabric from upholsterers Hendriks & Dekker is Real Green Nautolex, matching the fabrics used for sunpads, oiled teak Claverton armchairs and Bristolian steamer chairs from Gloster, and the luxury vantage points of a pair of Recaro Marine observation chairs. These chairs are on adjustable tracks and protected by the wraparound windshield. Equipped comprehensively, but not frivolously, *Solaia's* sun deck is fluently styled and carefully arranged to enable relaxed outdoor living for sun worshippers of all shades of exposure. 3



1. FLAMING CUISINE WITH A PALUX GAS WURST GRILL
2. AQUA GARANT ADAPTED SPA POOL, MADE BY SPAFORM
3. RECARO MARINE SEAT SUPPLIED BY EXALTO
4. LODIGE SUPPLIED THE BKG DUMB WAITER
5. GLOSTER FURNITURE'S BRISTOLIAN STEAMER